



PROPOSED SITE PLAN (1:500)

— REGULATED ENTERTAINMENT
 — SALE OF ALCOHOL

KEY TO LICENSING SYMBOLS (Note Existing fittings are marked 'EP')

- | | |
|---|---|
| ⊠ Emergency Lighting Luminaire | ⚠ 6L Wet Chemical (Fat Fighter) Fire Extinguisher |
| EXIT illuminated emergency exit sign mounted above door indicating escape route (pictorial on approach side) | ⚠ Foam Fire Extinguisher |
| EXIT illuminated emergency exit directional sign (pictorial on approach side), direction indicated | ⚠ 9L Water Fire Extinguisher |
| EXIT illuminated emergency exit sign suspended above head height 90-deg. to escape route (pictorial on approach side) | ⚠ 6L Hydrospray Fire Extinguisher |
| 🔊 Break Class Fire Alarm Manual call point | ⚠ Fire Blanket |
| 🔊 Fire Alarm electronic sounder | ⚠ Dry Powder Fire Extinguisher |
| 🔊 Heat/Smoke Detector | ⚠ 2kg. or 5kg. Carbon Dioxide Fire Extinguisher |
| 🔊 Fire Alarm Control Panel | ⚠ 9L F-Class Fire Extinguisher |
| ☀ Fire Alarm Zenon Beacon | 👁 Vision panel in door |
| FD30 30-minute fire resistant solid core door | 🚪 escape ironmongery (push bars/pads) on doors |
| FD30S 30-minute fire resistant solid core door with smoke seal | 🩹 First Aid kit box |
| FD60S one-hour fire resistant solid core door with smoke seal | |

THE CURRENT LOCATION OF FIRE SAFETY EQUIPMENT AND OTHER EQUIPMENT IS SHOWN. THESE MAY BE SUBJECT TO VARIATION / MOVEMENT IN THE FUTURE AS NECESSARY AND WHERE APPLICABLE CHANGE WILL BE DONE IN CONSULTATION WITH THE FIRE OFFICER.

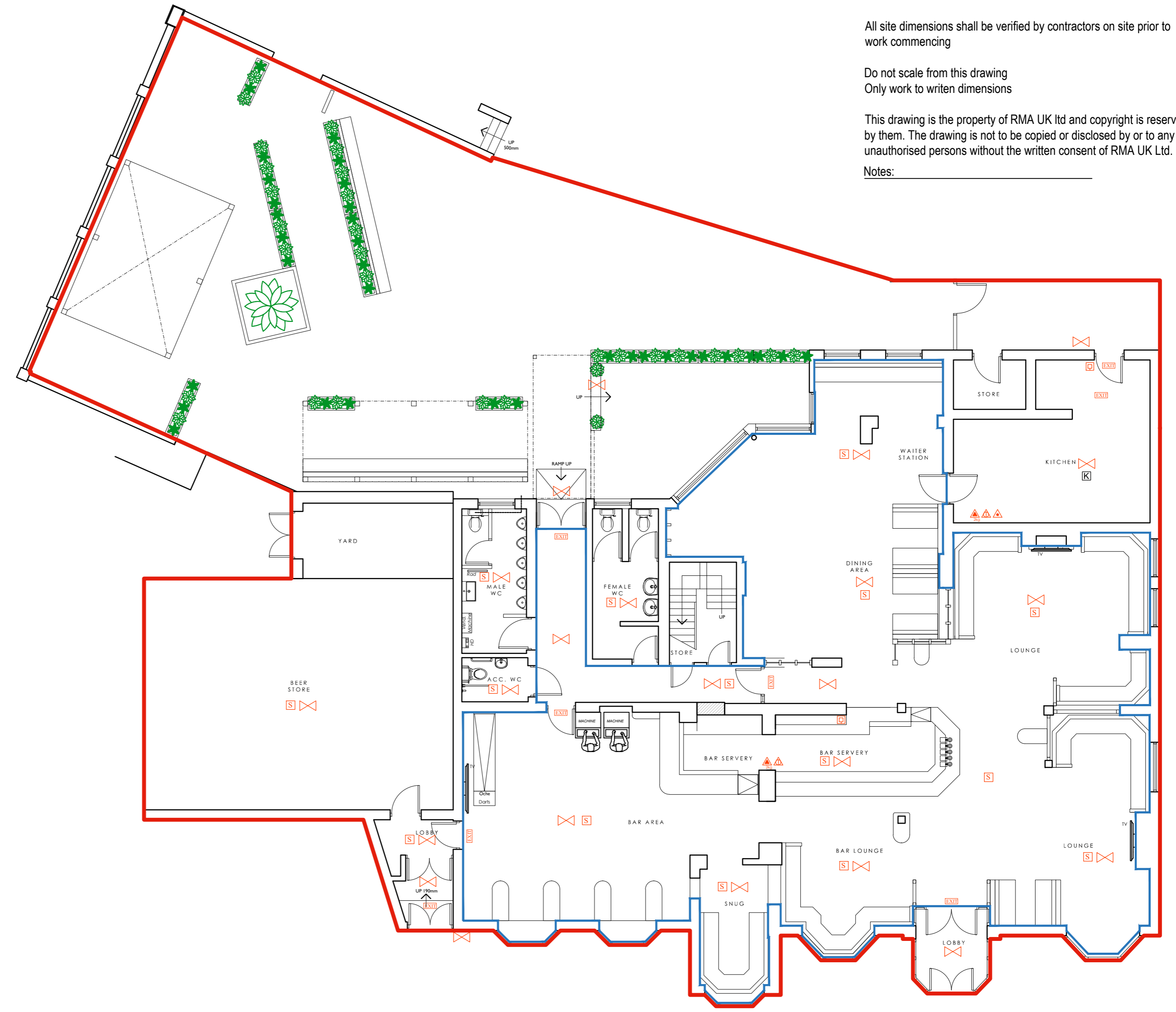

All site dimensions shall be verified by contractors on site prior to work commencing

Do not scale from this drawing
 Only work to written dimensions

This drawing is the property of RMA UK Ltd and copyright is reserved by them. The drawing is not to be copied or disclosed by or to any unauthorised persons without the written consent of RMA UK Ltd.

Notes: _____

PROPOSED GROUND FLOOR PLAN (1:100)

Rev.	Date	Details	Drawn	Checked
Issued for: LICENSING				
Project/Client: QUARRY BANK, TIMPERLEY, WA15 6NY			Project No: 1907	
Dwg No: LIC			Rev: -	
Drawing: Proposed Licensing Plans			Scale: 1:100 @A2	
Date: JUNE 2020			Drawn By: AR	
Checked By: -			Date: -	

rma
 The Stables, Stanney Brook Farm, Norley, CW8 2RX, Tel: 01928 787876